



By Appointment to  
HM Queen Elizabeth The Queen Mother  
Wheelchair Manufacturer  
Invacare  
Bridgend



## **Urgent Field Safety Notice**

### **Invacare REA Azalea wheelchair range** **Amendment of User Guide**

**FSN 026**

Date: 21<sup>st</sup> October 2009

Ref: 2008/011/020/061/008

#### **Urgent Safety Information:**

In the interests of the safety of our customers Invacare would like to bring your attention to an amendment of the user guide. The information regarding the safe use of the lap belt was inadequate in the previous version of Invacare Rea Azalea User manual. Incorrect use or adjustment of the lap belt can lead to adverse incidents.

The user manual has been amended to inform customers of how to use the lap belt safely, page 31. A copy of the information is attached with this Field Safety Notice.

If required, a complete copy of the amended user manual part number 1488727- 5, 090821 can be down-loaded from Invacare website – [www.invacare.co.uk](http://www.invacare.co.uk).

Please ensure that the information in this notice is made available to all relevant personnel within your organisation and / or customer base, and / or any organisation where the potentially affected devices have been transferred. Please also ensure that awareness is maintained for an appropriate period.

Invacare acknowledges that this may be an inconvenience; however it is not an option and must be done immediately to mitigate the potential safety risk.

If you have any questions relating to this bulletin, or should you require any additional information, please contact;

#### **Technical Services Department**

Tel. 01656 647327

Fax. 01656 753299

Invacare confirms that the relevant Competent Authorities have been informed of this Field Safety Corrective Action.

**INVACARE UK OPERATIONS LIMITED**

South Road Bridgend Industrial Estate Bridgend CF31 3PY

Sales/Technical Service Tel: 01656 647327 Fax: 01656 649016 Reception Tel: 01656 664321

Registered in the UK No. 3281202



HM



## PELVIC BELT

1.

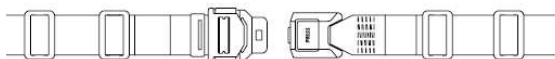

2-3.

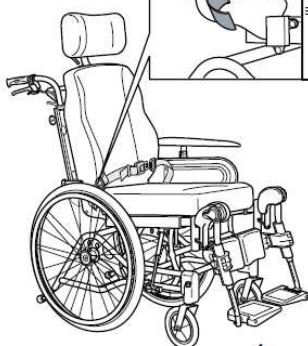
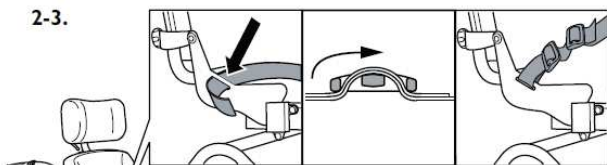

4.

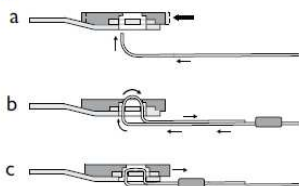

1. The pelvic belt is used to prevent the risk of falling or sliding out of the chair and for providing the user with a good posture.

2. The pelvic belt is mounted on the backrest brackets. Thread the belt through the mounting on the chair and then through the two plastic buckles as shown in the picture. It is important that both buckles are used. There is a danger the belt might slip if the belt is threaded through only one.

### 3. Adjustment

Ensure that the user is sitting fully back in the seat and that the pelvis is as upright and symmetrical as possible - not forward on one side or tilted back. Position the lap belt so that the hip bones can be felt above the belt. Adjust the length using the buckles so that there is just sufficient room for your hand to slide between your body and the belt. It is recommended that the clasp is kept in a central position, i.e. make adjustments to each side. These adjustments should be checked and possibly changed each time the belt is used.

4. If the belt has come loose at the metallic clasp it should be threaded according to the pictures a-c. Please make sure that the belt cannot slide.

## HARNESS

1.

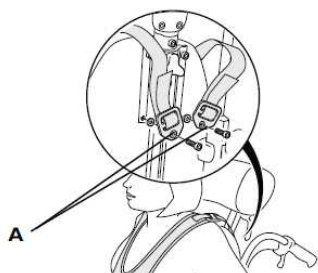

2.

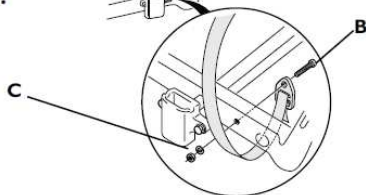

Tool: 5 mm Allen Key

rea Azalea

This item should be fitted by an experienced clinician or technician. The harness must always be used in combination with the pelvic belt and should be worn on top of the pelvic belt. Make sure that the harness does not put too much pressure on any point.

1. The harness is mounted on the headrest attachment. Remove screws and discard, position washers and harness as shown (A) and insert new screws through the eyelets into the attachment and tighten the screws.

2. To mount the lower straps, loosen the armrest attachments with the screws under the seat. Pull out the attachments approx. 5 cm. The strap-mountings should be fastened from the inside of the frame (see illustration 2). Insert the screw (B) through the eyelet and into the hole in the frame as shown. Secure with washer and nut (C). Put the armrest attachment back in its original place.

Always use a harness in combination with a pelvic belt to prevent the user from accidentally sliding down in the wheelchair.

The harness may not be used during transport in a vehicle.



F A X T R A N S M I S S I O N

MHRA REF: 2008/011/020/061/008
TO: Quality Department
FAX NUMBER: 01656 753244
SENT BY:
ORGANISATION:
REF: Completion of rework – Rea Azalea
NUMBER OF PAGES: 1

This is to confirm that the necessary corrective action, as documented in the Field Safety Notice, FSN 026, is now complete. The serial number(s) of the affected product(s) are as follows:

Signed.....
Company.....
Contact No..... Date.....